

NOTE:  
GASKET IS BLACK VITON A.

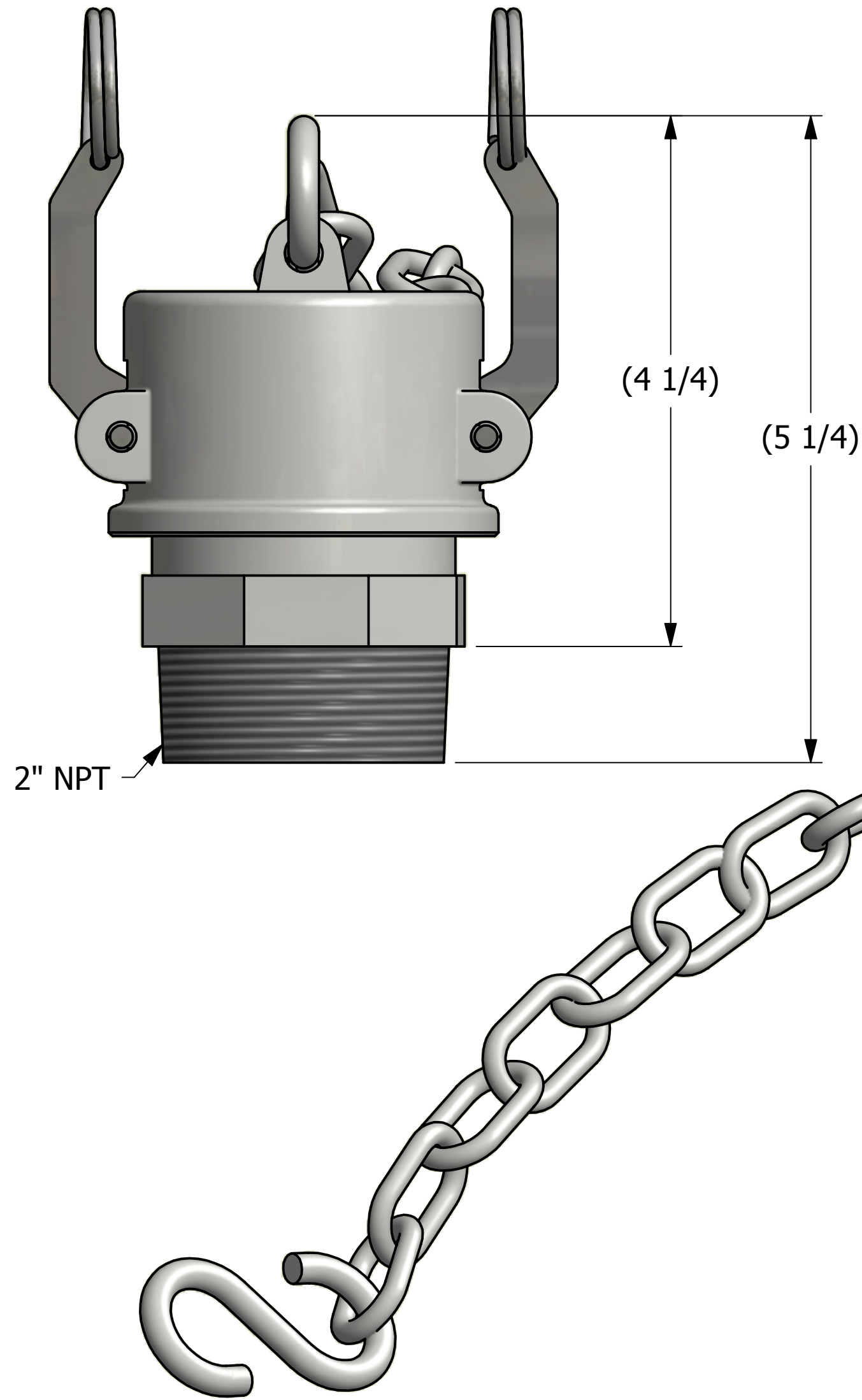

21 LINKS OF 3/16" STAINLESS STEEL CHAIN  
APPROX. 22" IN LENGTH

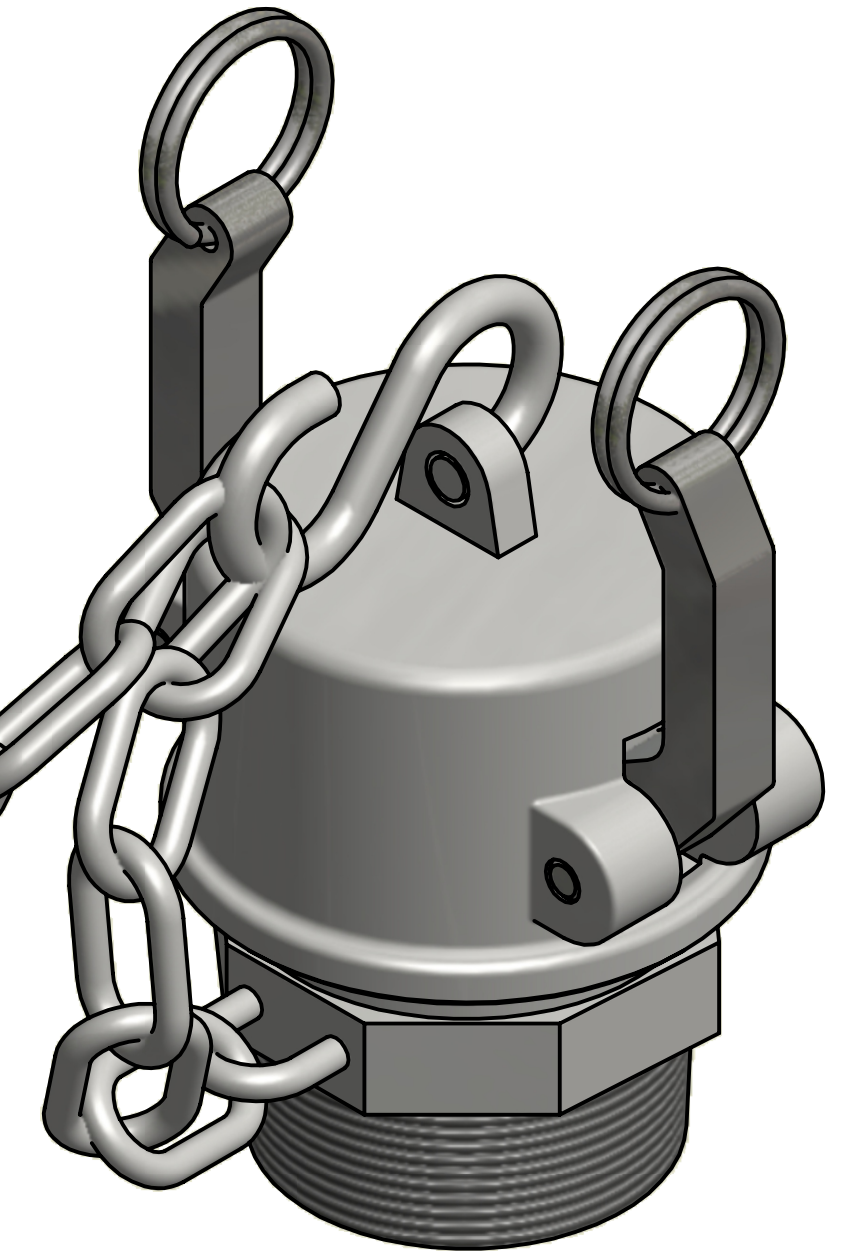

SALES DRAWING

SALES DRAWING

B	RJP	6-12-14	UPDATED DESIGN OF K20SDC6A	
A	RJP	12-03-13	RELEASED FOR PRODUCTION	
REV	BY	DATE	DESCRIPTION	
<b>SALCO PRODUCTS, INC.</b>				
PART NAME: <b>TOP FITTING ASSEMBLY 2" THREAD ON</b>				
MATERIAL: <b>316 SS</b>				
PROJECT #:		SHEET #:		SCALE:
<b>131114FR</b>		<b>1 OF 1</b>		<b>1:1</b>
DRAWING #:			PART #:	
<b>C37849</b>			<b>K20SUMP6A</b>	

UNLESS OTHERWISE SPECIFIED DIMENSIONAL TOLERANCES FRACTIONAL: $\pm 1/16$ X.XX: $\pm .03$ X.XXX: $\pm .015$ ANGLE: $\pm 1^\circ$ DEBURR ALL SHARP EDGES. ALL MACHINED SURFACES TO HAVE A 125 RMS FINISH UNLESS NOTED OTHERWISE. THIRD ANGLE PROJECTION	DRAWN BY:	RJP
	CHECKED BY:	CHL
	PROTOTYPE BY:	RJP
	PROTOTYPE DATE:	12/3/2013
	APPROVED FOR PRODUCTION BY:	VD
	PRODUCTION DATE:	12/3/2013

THIS PRINT, PROPERTY OF SALCO PRODUCTS INC., CONTAINS PROPRIETARY INFORMATION AND MUST NOT BE COPIED, REPRODUCED, OR USED DETRIMENTALLY TO OUR INTEREST.